

Mooring Spelter Sockets

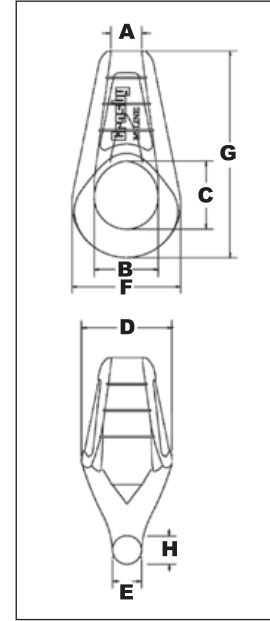

**G-517
Mooring
Spelter Socket**

- Wide range of sizes available:
 - 1-1/4" through 4" Wireline
- "M-Line" socket terminations have a 100% efficiency rating, based on the catalog strength of the wire rope. Ratings are based on recommended use with 6 x 7, 6 x 19, or 6 x 37 IPS or XIP (EIP), XXIP (EEIP), RRL, FC, or IWRC wire rope. Strand constructed with minimal number of wires (e.g. 1 x 7) requires special consideration that socket basket length be five (5) times the strand diameter or fifty (50) times the wire diameter, whichever is the greater.
- Galvanized finish
- Designed for today's higher strength classes of wire rope.
- Design of bail allows for easy connection to shackles and other connecting links.
- Socket design utilizes features to keep cone from rotating.



All Cast Mooring Sockets are Individually Magnetic Particle Inspected and Ultrasonic Inspected.

G-517 "M-Line" Mooring Sockets

Wire Rope Size		Ultimate Load (t)	G-517 Stock No.	Weight Each (lb)	Dimensions (in)							
(in)	(mm)				A	B	C	D	E	F	G	H
1-1/4 - 1-3/8	32-35	113	1004943	17	1.63	3.09	3.63	4.45	1.44	5.13	10.89	1.53
1-1/2 - 1-5/8	38-41	136	1004961	30	1.95	3.69	4.32	5.43	1.60	6.31	13.00	1.81
1-3/4 - 1-7/8	44-48	181	1004989	43	2.23	4.16	4.53	6.30	1.84	7.22	14.11	2.09
2 - 2-1/8	50-54	227	1005002	57	2.50	4.75	5.26	7.02	2.09	8.25	16.02	2.24
2-1/4 - 2-3/8	57-60	277	1005020	76	2.78	5.25	5.78	7.72	2.31	9.16	17.90	2.62
2-1/2 - 2-5/8	64-67	363	1005048	106	3.05	5.88	6.71	8.53	2.69	10.13	19.89	2.66
2-3/4 - 2-7/8	70-73	454	1005066	138	3.33	6.50	7.13	9.35	3.00	11.09	21.63	2.98
3 - 3-1/8	76-79	544	1005084	193	3.50	7.25	7.74	10.30	3.25	12.31	23.50	3.24
3-1/4 - 3-3/8	82-86	635	1005105	229	3.81	7.62	8.80	10.94	3.50	13.13	25.75	3.43
3-1/2 - 3-5/8	88-92	735	1005123	279	4.15	8.00	9.06	11.72	3.69	13.96	27.70	4.12
3-3/4 - 4	95-102	907	1005141	384	4.39	8.75	10.50	12.91	3.69	15.88	30.13	4.46